

SLS-IL10W

USER MANUAL

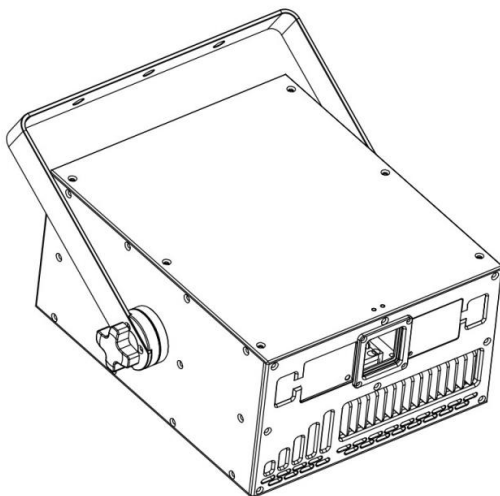

SLS-IL 10W (RGB) ANIMATION STAGE LIGHT

Please read this manual carefully before using the product

1. Introduction

Thank you for purchasing this product. We always try to develop our product with high-tech and high performance to meet your requirement and exception.

The unit is designed strictly according to the international standard. The control way is single or master-slave in option. The manual include the skill parameter and detail instructions. Please read this manual carefully before using the product.

After reading it, please keep it in a safe place for future reference.

This unit has been tested at our factory before being shipped to you, there is no assembly required.

Once after receiving this product, please take and put carefully. And check cautiously that whether the product was damaged or not during the transportation.

Checking parts

Please check if the following parts are included:

1 x Light

1 x User manual

1 x Power cable

Danger Light Radiation!

Avoid direct eye exposure!

Light radiation can cause eye damage or skin damage

All protective measures for a safe operation of this light must be applied.

Note: based on the policy of our company constantly upgrade the product improvement and contained in this manual. Data is likely to change in the future, and will not notice the alterations, the company keep in Product improvement when change the power of the relevant specification data. If you want to know the specific upgrades, please contact with sales department of the company, thank you. The publisher of this manual will not for the information in this manual is accurate is responsible for, also not due to the information the relevant consequences of any responsibility.

◎ SECURITY WARNINGS



2. Installation

1. Please check the voltage whether is the same with the one showed on the equipment or nor.
2. It must ask for the technical person and set the light safety when installation. And let the light beam at the suitable angle.
3. When install this equipment please make sure there's no flammable surface (decorated things, etc.) within at least 2.5M and maintain minimum distance of 0.5M from the equipment to the walls.
4. Please make sure that there's no other equipment or decoration materials obstructed the exhaust fan and the vent-pipe when the equipment is working.
5. Products should be install immobility and try to avoid strong shake or hit.
6. In case of safety, it's very important that to connect the earth with line.

3. Attention

1. Please do not open the bottom cover yourself without permission. Operate it according the user manual. Call the technician when the machine breaks down.
2. Please do not see the light beam directly to avoid any damage.
3. Before connect or disconnect the power, please adjust the luminance of the diode to the least to avoid any damage to the diode.
4. This unit should be keep dry, do not use in the rain and dusty environment. It can be use in the outdoor with the water-proof cover projector.
5. Before connect power, check the plug is immobility or not, power cable should be connect well.
6. Please do not open or close the equipment frequently that's to avoid any effect to the life span of the diode, and try the best to avoid long time working.
7. Due the the characteristic of the diode, after 4 hours working, it should be close at least 25 minutes until the diode cooling then work again.
8. Don't touch the light or draw the power cable when your hand was wet. And do not pull the electronic power line.
9. Maintain the distance at least 3M above from the equipment to the object.
10. This equipment does not have any parts can repair for users, please do not open the equipment.
11. When the diode become dim or damaged please contact he dealer timely.
12. When you want to re-transfer the products, you'd better use the original package to shockproof.

4. Technical Specifications

- 1. Rated voltage: AC 100V - 240V 50/60Hz
- 2. Power consumption: 260W@220V
- 3. Color: □single color, □RGB
- 4. DMX512 channel: 5CH/17CH/18CH/27CH/52CH
- 5. Control mode: music/ auto/ DMX512/ ILDA/ master-slave/ SD card
- 6. Cooling requirements: Intelligent air cooling cooling system
- 7. Operating temperature: 0°C - 35°C
- 8. Working environment: indoor
- 9. N.W./G.W. (2 in1) : 11.45KG/28KG
- 10. 2 in1 Package size: 48*43*47.5CM

5. Light control panel

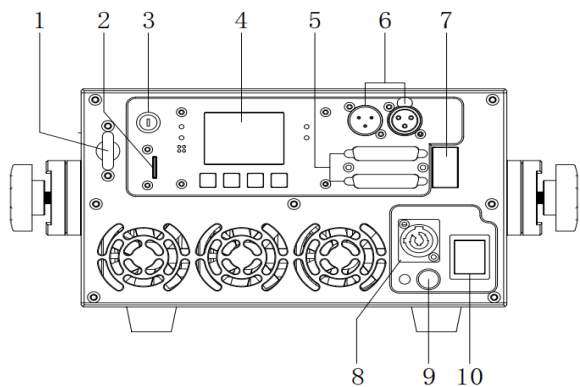

NO.	Interface
1	Safety rope to secure the ring

2	SD card
3	safe lock
4	Menu display window
5	DB25 ILDA interface (IN/OUT)
6	XLR Caron 3 core DMX-512 interface (IN/OUT)
7	RJ45- ILDA interface
8	Power input, connect to the external grid power supply
9	fuse holder
10	Power

6. Light Setting

Turn on the device, press the MENU button to ENTER the menu mode, press the ENTER button to enter the selected function, then use the UP/DOWN button to select the required function, and press the Enter button to confirm. To return to the main MENU press the Menu button. The main functions are as follows:

- TFT screen menu list as following

Menu	First Menu	Secondary Menu
DMX address	1-512 address ON/OFF	
Auto mode	Fast ON/OFF	
	Medium ON/OFF	
	Slow ON/OFF	
	Animation ON/OFF	
Sound mode	Fast ON/OFF	
	Medium ON/OFF	

	Slow ON/OFF	
	Animation ON/OFF	
SD mode	Loop play ON/OFF	
	Voice-activated ON/OFF	
	File 1/8	
	Directory 1/48	
Test mode	Test pattern	
System setting	Channel 27CH/52CH	
	Master/slave ON/OFF	
	Scanner protection ON/OFF	
	ILDA switch ON/OFF	
	Language CH/EN	
	Voice sensitivity 0-100	
	About	Channel Mode
		Operating Mode
		DMX Address
		Temperature
		Time
		Hardware Version
		Software Version
	Factory Settings Restoration	
Advanced Settings	Color RGB/G	
	Scanner 15-40k	
	Brightness 0-255	
	Design	Red 0-255
		Green 0-255

		Blue 0-255
		Over 0-255
		X 0-255
		Y 0-255
	X-axis reversal ON/OFF	
	Y-axis reversal ON/OFF	

DMX address

Select the DMX address and press ENTER to confirm. The current DMX address will be displayed on the screen. Use the UP/DOWN button to select addresses from 001 to 512, and press ENTER to save the Settings. Press the MENU button to return to the previous menu.

Automatic mode

Select automatic mode and press ENTER to confirm. The current mode will be displayed on the display screen. Use the UP/DOWN button to select four modes: fast rhythm, medium rhythm, slow rhythm and animation effect. Press ENTER button to save, and press MENU button to return to the upper-level menu.

Voice-activated mode

Select the voice control mode and press ENTER to confirm. The current mode will be displayed on the display screen. Use the UP/DOWN button to select four modes: fast tempo, medium tempo, slow tempo and animation effect. Press ENTER button to save, and press MENU button to return to the upper-level menu.

SD card mode

Select the SD card playing mode and press ENTER to confirm. The current mode will be displayed on the screen. Use the UP/DOWN button to select four modes: circular play, voice-activated trigger, directory, and file. Press

ENTER button to save, and press MENU button to return to the upper-level menu.

SD card playback Settings, the local system can read SD card 8 fixed folders, each folder can read 48 pattern files, pattern file format (.ild) format files. The UP and DOWN buttons can be used to select pattern files. If loop playback is set to ON, the whole SD folder is played in loop mode. (Selecting a single file name is invalid.) If you want to select a single file name to play, you need to return to loop playback and set to OFF. The UP and DOWN buttons can be used to select the mode to trigger the playback of the pattern file. ON is triggered by voice control, and OFF is automatically triggered

Insert the SD card into the lamp and select the SD card mode through the UP and DOWN buttons, or use the console to press the channel operation, you can play the SD card files. In the SD card mode, you can select folders and files through the UP and DOWN buttons to find the files you need, or use the console to operate to find the files you need. When selecting the SD card mode on the lamp, there are 3 modes (ONE for single FILE playback, FILE for single folder for ALL files playback, and all for the whole SD card file playback).

SD card file:

1. Create a folder in the root directory of the SD card. Only eight folders are supported, as shown in the following figure:

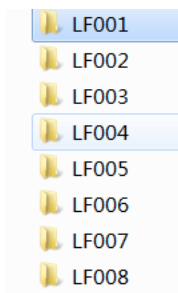

2. Put the standard (.ild) file in the folder you want to put in. Note: The file name can be self-named.

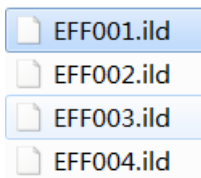

3. Folder playing order & folder content playing order:

When files in a single folder are played, they are played in the order in which they are copied to the SD, that is, the principle of "copy first, play first". If you need to change the play order, you can only copy the files in the order you need.

The entire SD card is played according to the fixed folder number (cyclic file F008 from LF001 to LF8) and in copy order.

SD card folders correspond to English and Chinese names		
file	English name (EN)	Chinese name (CH)
LF001	Animals	动物
LF002	Abstracts1	简单几何
LF003	Abstracts2	抽象几何

LF004	Music+Dancers	音乐&跳舞
LF005	People+Characters	人物&特性
LF006	Themes	主题
LF007	Logos+Text	Logo&文本
LF008	Shows	表演

Test mode

Select the test mode and press ENTER to confirm. The current mode will be displayed on the display screen. Use UP/DOWN button to select the test mode and test patterns 1~3 will appear on the current machine. Press ENTER button to save, and press MENU button to return to the upper-level menu.

System setting

Select System Settings and press ENTER to confirm. The current mode will be displayed on the screen. Use the UP/DOWN buttons to select channel number Settings, master/slave Settings, vibrator protection, ILDA switch, language, voice sensitivity, about (channel mode, operating mode, current DMX address code, case temperature, running time, hardware version, software version), and restore factory Settings. Press ENTER button to save, and press MENU button to return to the upper-level menu.

Advanced Settings

Select Advanced Settings and press ENTER to confirm. The current mode will be displayed on the display screen. Use the UP/DOWN button to select color Settings, galvanometer, overall brightness, design (red light brightness, green light brightness, Blue light brightness, overall size, X-axis size, Y-axis size), X-axis reverse and Y-axis

reverse. Press ENTER button to save, and press MENU button to return to the upper-level menu.

7. Light Control mode

① 12 control mode:

MX512 address code, the lamp will receive standard DMX512 signal.

② Master/slave mode:

Host - In the main menu, press UP and DOWN to enter the menu of "System Settings"/Host Settings as a check mark (default is a cross), then the lamp is the host. Press ENTER button to save, and press MENU button to return to the previous menu.

Slave - In the main MENU, press UP and DOWN to enter the menu of "System Settings"/Slave machine set to cross (default is cross), press Menu button to return to the menu of "DMX Address". DMX address set to 001.

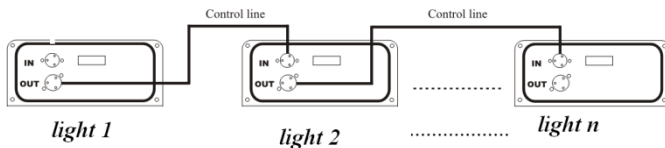

③ Automatic mode

When the lamp does not receive the external signal, the equipment can choose to run automatically.

8. DMX512 Control

8.1 DMX512 Connect

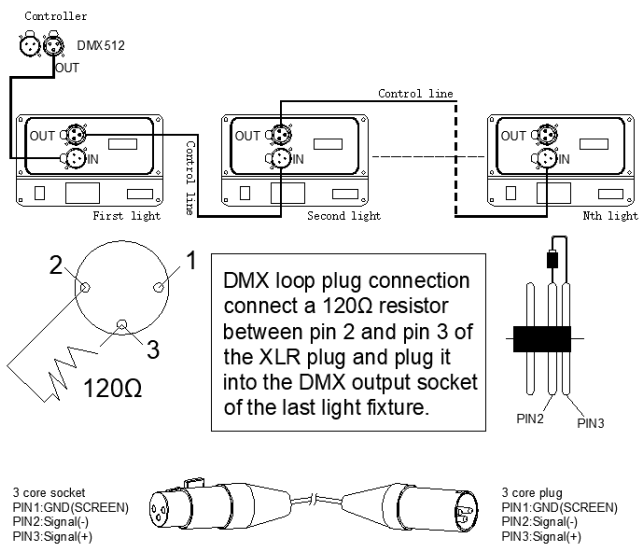

1. In order to reduce signal errors and avoid signal weakening or interference during transmission, a 120Ω resistance loop can be inserted between the 2 cores and the 3 cores of the DMX output terminal of the last machine.

2. Connect the lamp with XLR signal, one end is connected to the output port of the lamp, and the other end is connected to the input port of the next lamp. XLR signal lines can only be used in series, not in parallel. DMX512 signal transmission speed is very fast. Damage to the signal line, weak welding, poor contact, etc., will affect the signal transmission and cause the system to shut down.

3. When a unit of machine power disconnect, DMX output or input connection is bypass, in order to maintain the DMX line and connectivity.

4. Each lamp must have an address code, which can receive the information sent by the console, ranging from 1 to 512.

5. The terminal of the DMX512 system needs to be equipped with a

terminator to reduce signal transmission errors.

6. The 3-pin XLR connector is more common than the 5-pin XLR:

3 pin XLR: PIN1: GND, PIN2: - Signal , PNI3: + Signal

5 pin XLR: PIN1: GND, PIN2: - Signal, PIN3: + Signal, PIN4/PIN5:No
USE

8.2 DMX512 channel setting:

Press the MENU button to enter the menu mode, select the system setting/channel mode (5CH), select the channel mode you need, and press the ENTER key to confirm.

Connect the XLR control line from the DMX output of the controller to the DMX input of each luminance, and so on until all the luminance are connected, and then connect the loop plug to the signal output of the last luminance to complete the connection, as following :

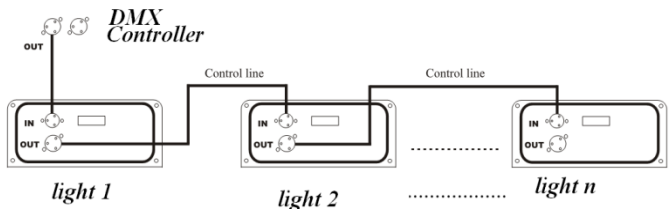

When using any controller, each device must have its own address code. So, if the address of the first lamp is set to 1 and the address code of the second lamp is set to 6/18/19/28/53 and the address code of the first lamp is set to 1 plus 5/17/18/27/52 channels, the third lamp is set to 11/35/37/55/105CH. And so on (this setting also needs to be determined according to different console, now only according to the general convention).

Specific dmX-512 signal control mode address code switch settings are as follows:

Fixture No.	Address	LED display (ON)
-------------	---------	------------------

1	1	1
2	6/18/19/28/53	006/018/019/028/053
3	11/35/37/55/105CH	011/035/037/055/105CH
⋮	⋮	⋮

8.3 DMX-512 Channel introduce:

This light pattern mode has 5 channel modes 5/17/18/27/52CH (the operation mode can be selected from the console mode → channel mode setting), SD mode is not affected by the channel number setting, SD PLAY has 3 channel modes 5/17/20CH, (when the channel mode is 5CH, SD card mode 5CH is valid. SD card mode 17CH is valid when the channel mode is 17/18CH, and SD card mode 20CH is valid when the channel mode is 27/52CH.) The modes and descriptions are as follows:

Channel	Content		
CH1	Patterns	0~31	Blackout
		32~63	Manual choose cue
		64~95	Auto trigger macro function
		96~127	Voice activated auto macro function
	SD card mode	128~159	Manual drawing selection
		160~191	Folder Play
		192~223	Voice-activated manual image selection
		224~255	Voice control triggers folder playback

IPLAY mode of this lamp has one channel mode 5CH (channel mode can be checked in system setting → channel number setting), which is described as follows:

When CH1 =32 ~ 63, all channels are valid.

When CH1= 64 ~ 127, CH2 and CH6 are effective for automatic control.

5CH

Channel		value	Content
CH1	Cue mode	0 ~ 31	OFF (blackout)
		32 ~ 63	Manual choose cue
		64 ~ 95	Auto trigger macro function
		96 ~ 127	Sound trigger macro function
	SD Card	128 ~ 255	Please read SD card 5CH on page 28
CH2	Dimmer	0 ~ 255	Brightness 0% ~ 100%
CH3	List (CH1: 32 ~ 63)	0 ~ 255	List :each 32 value be 1 list, 8 lists total.
	Macro effect (CH1: 64 ~ 95)		List: when the value is 0, all loop, 1-255 ,each 3 value be 1 macro function, 85 macro function total.
CH4	cue	0 ~ 15	OFF (blackout)
		16 ~ 255	each 12 value be 1 cue, 20 cues total.
CH5	zoom	0 ~ 255	100% ~ 0%

17CH:

Channel	Content		
CH1	Cue mode	0 ~31	OFF (Blackout)
		32 ~63	Manual choose cue
		64 ~95	Auto trigger macro function
		96 ~127	Sound trigger macro function
	SD card	128 ~255	Please read SD card 17CH on page 29

CH2	dimmer	0 ~255	0% - 100%		
CH3	red	0 ~255	0% - 100%		
CH4	green	0 ~255	0% - 100%		
CH5	blue	0 ~255	0% - 100%		
CH6	List (CH1: 32 ~ 63)	0 ~ 255	List :each 32 value be 1 list, 8 lists total.		
	Macro effect (CH1: 64 ~ 95)		List: when the value is 0, all loop, 1-255 ,each 3 value be 1 macro function, 85 macro function total.		
CH7	Cue	0 ~15	OFF (Blackout)		
		16 ~255	Each 12 value be 1 cue, 20 cues total;		
CH8	X position	0 ~255	Left- right (128 center)		
CH9	Y position	0 ~255	Up - down (128 center)		
CH10	Rotation	0 ~255	Clockwise rotation (0°-360°)		
CH11	Zoom	0 ~255	100% - 0%		
CH12	X flip	0 ~255	Left - right		
CH13	Y flip	0 ~255	Up - down		
CH14	Color	0 ~7	default	8 ~15	white
		16 ~23	red	24 ~31	yellow
		32 ~39	green	40 ~47	cyan
		48 ~55	blue	56 ~63	purple
		64 ~127	Each 8 value be 1 color effect, 8 effects total		
		128 ~143	Macro 1	144 ~159	Macro 2
		160 ~175	macro 3	176 ~191	macro 4
		192 ~207	macro 5	208 ~223	macro 6

		224 ~239	macro 7	240 ~255	macro 8
CH15	Write in	0 ~255	100%-0		
CH16	Deformation	0 ~15	Invalid		
		16~223	Each 15 value be 1 macro effect, total 13 effects, (match CH11 zoom)		
		224 ~255	default		
CH17	Wave	0	invalid	1 ~39	macro 1
		40 ~79	macro 2	80 ~119	macro 3
		120 ~159	macro 4	160 ~199	macro 5
		200 ~255	macro 6		

18CH:

Channel	Content		
CH1	Cue mode	0 ~31	OFF (Blackout)
		32 ~63	Manual choose cue
		64 ~95	Auto trigger macro function
		96 ~127	Sound trigger macro function
	SD card	128 ~255	Please read SD card 17CH on page 29
CH2	dimmer	0 ~255	0%- 100%
CH3	List (CH1: 32 ~ 63)	0 ~ 255	List :each 32 value be 1 list, 8 lists total.
	Macro effect (CH1: 64 ~ 95)		List: when the value is 0, all loop, 1-255 ,each 3 value be 1 macro function, 85 macro function total.
CH4	Cue	0 ~15	OFF (Blackout)
		16 ~255	Each 12 value be 1 cue, 20 cues

			total;
CH5	X position	0 ~255	Left- right (128 center)
CH6	Y position	0 ~255	Up - down (128 center)
CH7	Zoom	0 ~255	100% - 0%
CH8	X flip	0 ~255	Left - right
CH9	flip	0 ~255	Up - down

CH10	color	0 ~7	default	8 ~15	white
		16 ~23	red	24 ~31	yellow
		32 ~39	green	40 ~47	cyan
		48 ~55	blue	56 ~63	purple
		64 ~127	Each 8 value be 1 effect, 8 effects total.		
		128 ~143	macro 1	144 ~159	macro 2
		160 ~175	macro 3	176 ~191	macro 4
		192 ~207	macro 5	208 ~223	macro 6
		224 ~239	macro 7	240 ~255	macro 8
CH11	Deformation	0 ~15	invalid		
		16~31	Each 15 value be 1 macro effect, total 13 effects, (match CH7, CH16 zoom)		
		224 ~255	default		
CH12	Wave	0	invalid	1 ~39	macro 1
		40 ~79	macro 2	80 ~119	macro 3
		120 ~159	macro 4	160 ~199	macro 5
		200 ~255	macro 6		
CH13	X position	0	valid	1 ~32	macro 1
		33 ~64	macro 2	65 ~96	macro 3

		97 ~128	macro 4	129 ~160	macro 5
		161 ~192	macro 6	193 ~224	macro 7
		225 ~255	macro 8		
CH14	Y position	0	invalid	1 ~32	macro 1
		33 ~64	macro 2	65 ~96	macro 3
		97 ~128	macro 4	129 ~160	macro 5
		161 ~192	macro 6	193 ~224	macro 7
		225 ~255	macro 8		
CH15	Z rotation	0	invalid	1 ~32	macro 1
		33 ~64	macro 2	65 ~96	macro 3
		97 ~128	macro 4	129 ~160	macro 5
		161 ~192	macro 6	193 ~224	macro 7
		225 ~255	macro 8		
CH16	Zoom	0	invalid	1 ~32	macro 1
		33 ~64	macro 2	65 ~96	macro 3
		97 ~128	macro 4	129 ~160	macro 5
		161 ~192	macro 6	193 ~224	macro 7
		225 ~255	macro 8		
CH17	X flip	0	invalid	1 ~32	macro 1
		33 ~64	macro 2	65 ~96	macro 3
		97 ~128	macro 4	129 ~160	macro 5
		161 ~192	macro 6	193 ~224	macro 7
		225 ~255	macro 8		
CH18	Y flip	0	invalid	1 ~32	macro 1
		33 ~64	macro 2	65 ~96	macro 3
		97 ~128	macro 4	129 ~160	macro 5

		161 ~192	macro 6	193 ~224	macro 7
		225 ~255	macro 8		

27CH/52CH:

Channel			Content	
27CH	52CH	Value	27CH indicates a single pattern and 52CH indicates a double pattern	
CH1		0~31	Blackout	Patterns
		32~63	Manual choose cue	
		64~95	Auto mode	
		96~127	Voice activated auto mode	
		128~255	Please refer to the SD card channel pattern table	SD card mode
CH2		0~255	Total	
CH3	CH28	0~255	Red	
CH4	CH29	0~255	Green	
CH5	CH30	0~255	Blue	
CH6	CH31	0~255	CH1: 32~63, Each 32 value be 1 list, total 8 list	
			CH1: 64~95; CH1: 96~127 0 numerical loop all; 1-255 Every 3 values is a macro function effect, a total of 85;	
CH7	CH32	0~15	Blackout	
		16~255	Each 12 value be 1 cue, total 20 cues	
CH8	CH33	0~255	Left right (128 center)	
CH9	CH34	0~255	X fine position	
CH10	CH35	0~255	Downup (128 center)	

CH11	CH36	0~255	Y fine position				
CH12	CH37	0~255	Rotation				
CH13	CH38	0~255	Fine rotation				
CH14	CH39	0~255	100%....0%				
CH15	CH40	0~255	Left...right				
CH16	CH41	0~255	Down ... up				
CH17	CH42	color					
		0~7	default	8~63	7 color		
		64~127	Color effects (1 effect for every 8 values, 8 in total)				
		128~143	Macro 1	144~159	Macro 2		
		160~175	Macro 3	176~191	Macro 4		
		192~207	Macro 5	208~223	Macro 6		
		224~239	Macro 7	240~255	Macro 8		
CH18	CH43	0~255	Write in,Visible point 100%-0				
CH19	CH44	Deformation（valid for 14CH 25CH ）					
		0~15	Invalid	16~31	Macro 1	32~47	Macro 2
		48~63	Macro 3	64~79	Macro 4	80~95	Macro 5
		96~111	Macro 6	112~127	Macro 7	128~143	Macro 8
		144~159	Macro 9	160~175	Macro 10	176~191	Macro 11
		192~207	Macro 12	208~223	Macro 13	224~255	default
CH20	CH45	wave					
		1~39	Macro 1	40~79	Macro 2	80~119	Macro 3
		120~159	Macro 4	160~199	Macro 5	200~255	Macro 6
CH21	CH46	Write in（invalid if the value is 0）					
		1~42	Macro 1	43~84	Macro 2	85~126	Macro 3
		127~255	Flash（0-100%）				
CH22	CH47	X position					
		0	Invalid	1~32	Macro 1	33~64	Macro 2

		65～96	Macro 3	97～128	Macro 4	129～160	Macro 5
		161～192	Macro 6	193～224	Macro 7	225～255	Macro 8
CH23	CH48	Y position					
		0	Invalid	1～32	Macro 1	33～64	Macro 2
		65～96	Macro 3	97～128	Macro 4	129～160	Macro 5
		161～192	Macro 6	193～224	Macro 7	225～255	Macro 8
CH24	CH49	Rotation					
		0	Invalid	1～32	Macro 1	33～64	Macro 2
		65～96	Macro 3	97～128	Macro 4	129～160	Macro 5
		161～192	Macro 6	193～224	Macro 7	225～255	Macro 8
CH25	CH50	Zoom					
		0	Invalid	1～32	Macro 1	33～64	Macro 2
		65～96	Macro 3	97～128	Macro 4	129～160	Macro 5
		161～192	Macro 6	193～224	Macro 7	225～255	Macro 8
CH26	CH51	X flip					
		0	Invalid	1～32	Macro 1	33～64	Macro 2
		65～96	Macro 3	97～128	Macro 4	129～160	Macro 5
		161～192	Macro 6	193～224	Macro 7	225～255	Macro 8
CH27	CH52	Y flip					
		0	Invalid	1～32	Macro 1	33～64	Macro 2
		65～96	Macro 3	97～128	Macro 4	129～160	Macro 5
		161～192	Macro 6	193～224	Macro 7	225～255	Macro 8

SD card 5CH:

Channel	Content
---------	---------

CH1	Patterns	0~31	Blackout
		32~63	Manual choose cue
		64~95	Auto mode
		96~127	Voice activated auto mode
	SD card mode	128~159	Manual choose cue
		160~191	Folder Play
		192~223	Voice activated auto mode
		224~255	Voice activated folder mode
CH2	Total	0~255	Fade 0% 100%
CH3	Folder	0~255	Each 32 value be 1 list, total 8 list
CH4	Material	0~15	Blackout
		16~255	Every 5 values is a material, a total of 48
CH5	Zoom	0~255	Fade 100%....0%

SD card 17CH:

Channel	Content		
CH1	Patterns	0~31	Blackout
		32~63	Manual choose cue
		64~95	Auto mode
		96~127	Voice activated auto mode
	SD card mode	128~159	Manual choose cue
		160~191	Folder Play
		192~223	Voice activated auto mode
		224~255	Voice activated folder mode

CH2	Total	0~255	Fade 0% 100%		
CH3	Red	0~255	Fade 0% 100%		
CH4	Green	0~255	Fade 0% 100%		
CH5	Blue	0~255	Fade 0% 100%		
CH6	Folder	0~255	Each 32 values is a folder, a total of 8;		
CH7	Material	0~15	Blackout		
		16~255	Each 5 value be 1 cue, total 48 cues		
CH8	X position	0~255	Left right (128 center)		
CH9	Y position	0~255	Downup (128 center)		
CH10	Rotation	0~255	Clockwise rotation (0°-360°)		
CH11	Zoom	0~255	100%....0%		
CH12	X flip	0~255	Left...right		
CH13	Y flip	0~255	Down ... up		
CH14	Color	0~31	Default	32~63	White
		64~95	Red	96~127	Yellow
		128~159	Green	160~191	Cyan
		192~223	Blue	224~255	Purple
CH15	Write in	0~255	Visible point 100%-0		
CH16	Speed	0~15	Default		
		16~31	Pause		
		32~255	25% - 200%		
CH17	Scan rate	0~31	Default		

		32~223	6k - 29k
		224~255	30k

SD card 20CH:

Channel	Parameter	Value	Parameter description
CH1	IPLAY mode	0~31	Black
		32~63	Manual play
		64~95	Auto play
		96~127	Music play
	SD mode	128~159	Manual play
		160~191	Auto play
		192~223	Music play (one file)
		224~255	Music play (all files loop)
CH2	Dimmer	0~255	Brightness 0% 100%
CH3	Red	0~255	Brightness 0% 100%
CH4	Green	0~255	Brightness 0% 100%
CH5	Blue	0~255	Brightness 0% 100%
CH6	List	0~255	Each 32 value be 1 list, total 8 list
	Macro		each 10 value be 1 macro, total 25 macro
CH7	Cue	0~15	Black
		16~255	Each 12 value be 1 cue, total 20 cues
CH8	X position	0~255	Left right (128 center)
CH9	X fine	0~255	X fine position
CH10	Y position	0~255	Updown (128 center)
CH11	Y fine	0~255	Y fine position
CH12	Rotation	0~255	Clockwise rotation (0° -360°)

CH13	Fine rotation	0~255	Fine rotation
CH14	Zoom	0~255	100%...0%
CH15	X flip	0~255	Left...right
CH16	Y flip	0~255	Down ... up
CH17	Color	0~31	Default
		32~63	White
		64~95	Red
		96~127	Yellow
		128~159	Green
		160~191	Cyan
		192~223	Blue
		224~255	Purple
CH18	Write in	0~255	Visible point 100%-0
CH19	Speed	0~15	Default
		16~31	Pause
		32~255	25% - 200%
CH20	Scan rate	0~31	Default
		32~223	6k - 29k
		224~255	30k

11. Built-in effect pattern sheet

	DMX数值	图案组1	图案组2	图案组3	图案组4	图案组5	图案组6	图案组7
图案	0-15	无效 (闭光)						
图案1	16-27							
图案2	28-41							HELLO I
图案3	42-53							happy
图案4	54-63							Merry Christmas
图案5	64-75							happy New Year
图案6	76-87							thank you
图案7	88-99							happy wedding
图案8	100-111							Valentine's Day
图案9	112-123							Happy Birthday
图案10	124-135							congratulation
图案11	136-147							喜喜
图案12	148-159							福

图案13	160-171							1
图案14	173-184							2
图案15	185-195							3
图案16	196-207							4
图案17	208-219							5
图案18	220-231							6
图案19	232-243							7
图案20	244-255							8

12. Maintenance

Maintenance should be performed every 3 month, different period according to the environment. Use a sponge which is dipped with alcohol, rather than wet cloth or other chemical liquid, to clean the mirror.

Always disconnect from the power before maintenance .

13. Warning and Declaration

Do not look at the light source directly. Power must be disconnected before install and maintenance.

This device has left our premises in absolutely perfect condition. In order to maintain this condition and to ensure a safe operation, it is absolutely necessary for the user to follow the safety instructions and the warning note written in his user manual.

We cannot be made liable for damages caused by incorrect installations and unskilled operation!

Product common breakdown comparison table	
breakdown cause	Major breakdown analysis and solution
The fixture no light or no work	1.Check the power cable whether to connect the fixture, whether the fuse does bum out. 2.Check the input voltage whether to assign the voltage match with the fixture.
No sound control	1.Check the address code or the display whether establishes according to the instruction booklet is the voice control pattern. 2.Check the potentiometer possibly moves is smallest, attempt to adjust the potentiometer.
The fixture can bright normally, but it not controlled by controller	1. Please check the fixtures' DIP outset address setting whether correctly. 2.Please check the XLR signal cable whether be damage.
Master-slave mode,	1.Please conformed only one for the master and the master without DMX be connected, and to set master

the master mode is normal, but slave mode is not normal	as sound control or auto pattern. 2.If the Master-slave setting is right but still have problem, please check the XLR connect cable.
The button malfunction, does not work.	1.Check the buttons whether to have some button not to have the normal reset.
The fixtures' brightness obvious dim	1.Check the LED tubes or the light already whether to be service life. 2.Check the internal and external optical system whether to be clean.
If above method cannot eliminate the fault, please consult the dealer.	



Móvil: +34 638 626 631
www.soundlightspain.com